

| PIN | SYMBOL |
|-----|-----------|
| 1 | VSS |
| 2 | VDD(5V) |
| 3 | V0 |
| 4 | RS |
| 5 | RW |
| 6 | E |
| 7 | DB0 |
| 8 | DB1 |
| 9 | DB2 |
| 10 | DB3 |
| 11 | DB4 |
| 12 | DB5 |
| 13 | DB6 |
| 14 | DB7 |
| 15 | LED-A(5V) |
| 16 | LED-K |

SPECIFICATIONS:

- | | |
|---------------------------|-------------------------------------|
| 1. DISPLAY TYPE: | STN / POSITIVE (YG) / TRANSFLECTIVE |
| 2. DRIVE IC: | AIP31066 or EQV. |
| 3. CONNECTOR: | ZEBRA |
| 4. OPERATING VOLTAGE: | VOP = 4.7 V, VDD = 5.0V |
| 5. OPERATING TEMPERATURE: | -20 ~ 70°C |
| 6. STORAGE TEMPERATURE: | -30 ~ 80°C |
| 7. DRIVE MODE: | 1/16 DUTY, 1/5 BIAS |
| 8. VIEWING ANGLE: | 6 O'CLOCK |
| 9. BACKLIGHT: | YELLOW-GREEN LED, I = 40mA |
| 10. CUSTOMER PART NO.: | BOCEN STANDARD PRODUCT |

BOCEN DISPLAY TECHNOLOGY CO., LTD.

DESIGNED BY: Shawn

BB2002-01

VERSION: 1.0

CHECKED BY: William

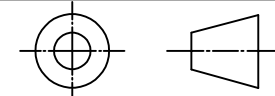

NO.: 1 OF 1

APPROVED BY: Rio

UNIT: mm

Website: <http://www.bocentech.com>

DATE: 2011-11-7